

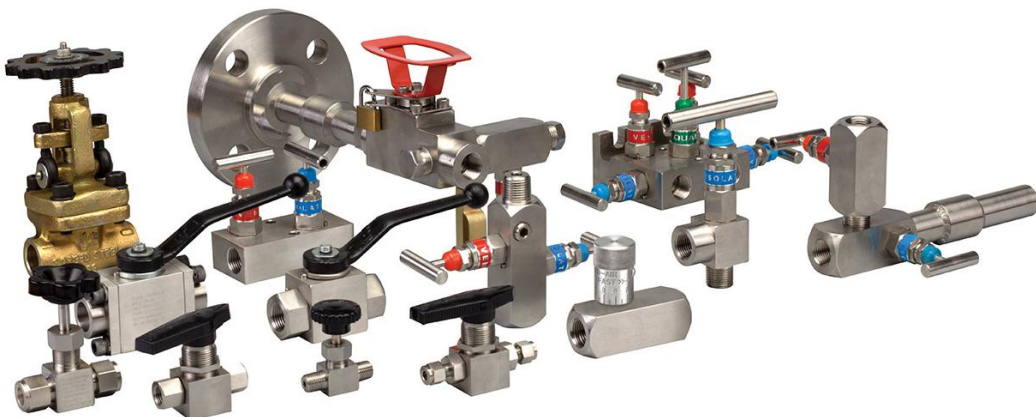

METALOK INDUSTRIES
(AN ISO 9001: 2008 Certified Company)

**Manufacturer of wide range of
Fittings and Valves
For Instrumentation, Hydraulic
& Precise Industrial Applications**



METALOK INDUSTRIES

sales@metalokindustries.com



M
E
T
A
L
O
K

I
N
D
U
S
T
R
I
E
S



 1	 2	 3
FULL COUPLINGS	ROUND HEAD PLUG	HALF COUPLING
 4	 5	 6
SQUARE HEAD PLUG	HEX HEAD PLUG	HEX HEAD BUSHING
 7	 8	 9
UNION	BULL PLUG	BOSS
 10	 11	 12
SWAGE NIPPLES	SWAGE NIPPLES	SWAGE NIPPLES
 13	 14	
PIPE NIPPLES	<u>UNION MALE X FEMALE</u>	

Dimensions are for reference only and subject to change without notice.

Warning for Your Safety

The system designer and user have the sole responsibility to select products suitable for their special application requirements to ensure the proper installation. Operation and maintenance of the product. Application details, material compatibility and product ratings should all be considered in the individual selection. Improper selection or use of products can cause property damage or personal injury. METALOK accepts no liability for any improper selection, installation, operation or maintenance.

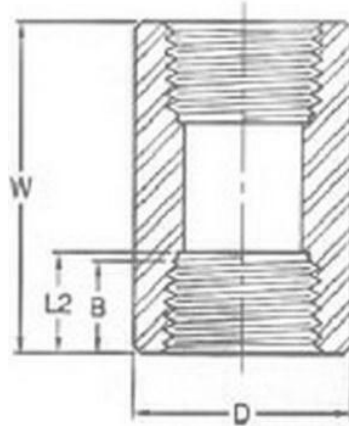

DN	Nom. Pipe Size	Center End Coupling W		Center End Cap P		Outside Diameter D		End Wall Thickness G Min.		Length of Thread Min.(1)	
		3000 & 6000	3000	6000	3000	6000	3000	6000	B	L2	
6	1/8"	32	19		16		4.8		6.4	6.7	
8	1/4"	35	25	27	19	25	4.8	6.4	8.1	10.2	
10	3/8"	38	25	27	22	32	4.8	6.4	9.1	10.4	
15	1/2"	48	32	33	28	38	6.4	7.9	10.9	13.6	
20	3/4"	51	37	38	35	44	6.4	7.9	12.7	13.9	
25	1"	60	41	43	44	57	9.7	11.2	14.7	17.3	
32	1-1/4"	67	44	46	57	64	9.7	11.2	17.0	18.0	
40	1-1/2"	79	44	48	64	76	11.2	12.7	17.8	18.4	
50	2"	86	48	51	76	92	12.7	15.7	19.0	19.2	
65	2-1/2"	92	60	64	92	108	15.7	19.0	23.6	28.9	
80	3"	108	65	68	108	127	19.0	22.4	25.9	30.5	
100	4"	121	68	75	140	159	22.4	28.4	27.7	33.0	

(1) Dimensions In Millimeters

(2) Dimension B is minimum length of perfect thread. The length of useful thread (B plus threads with fully formed roots and flat crests) shall not be less than L2 (effective length of external thread) required by American National Standard for Pipe Threads (ANSI/ASME B1.20.1)

Dimensions are for reference only and subject to change without notice.

Warning for Your Safety

The system designer and user have the sole responsibility to select products suitable for their special application requirements to ensure the proper installation. Operation and maintenance of the product. Application details, material compatibility and product ratings should all be considered in the individual selection. Improper selection or use of products can cause property damage or personal injury. METALOK accepts no liability for any improper selection, installation, operation or maintenance.

ROUND HEAD PLUG

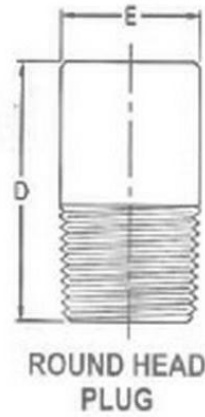

DN	Pipe Size	Length Min A	Round Head Plug	
			Nominal Head (Nom) E	Length (Min.) D
6	1/8"	10	10	35
8	1/4"	11	14	41
10	3/8"	13	18	41
15	1/2"	14	21	44
20	3/4"	16	27	44
25	1"	19	33	51
32	1-1/4"	21	43	51
40	1-1/2"	21	48	51
50	2"	22	50	64
65	2-1/2"	27	73	70
80	3"	28	89	70
100	4"	32	114	76

Dimensions are for reference only and subject to change without notice.

Warning for Your Safety

The system designer and user have the sole responsibility to select products suitable for their special application requirements to ensure the proper installation. Operation and maintenance of the product. Application details, material compatibility and product ratings should all be considered in the individual selection. Improper selection or use of products can cause property damage or personal injury. METALOK accepts no liability for any improper selection, installation, operation or maintenance.



HALF COUPLING

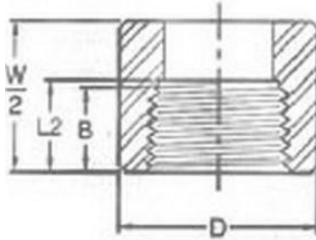

DN	Nom Pipe Size	Center End Coupling W	Center End Cap P		Outside Diameter D		End Wall Thickness G Min.		Length of Thread Min.(1)	
			3000	6000	3000	6000	3000	6000	B	L2
		3000 & 6000	3000	6000	3000	6000	3000	6000	B	L2
6	1/8"	32	19		16		4.8		6.4	6.7
8	1/4"	35	25	27	19	25	4.8	6.4	8.1	10.2
10	3/8"	38	25	27	22	32	4.8	6.4	9.1	10.4
15	1/2"	48	32	33	28	38	6.4	7.9	10.9	13.6
20	3/4"	51	37	38	35	44	6.4	7.9	12.7	13.9
25	1"	60	41	43	44	57	9.7	11.2	14.7	17.3
32	1-1/4"	67	44	46	57	64	9.7	11.2	17.0	18.0
40	1-1/2"	79	44	48	64	76	11.2	12.7	17.8	18.4
50	2"	86	48	51	76	92	12.7	15.7	19.0	19.2
65	2-1/2"	92	60	64	92	108	15.7	19.0	23.6	28.9
80	3"	108	65	68	108	127	19.0	22.4	25.9	30.5
100	4"	121	68	75	140	159	22.4	28.4	27.7	33.0

(1) Dimensions In Millimeters

(2) Dimension B is minimum length of perfect thread. The length of useful thread (B plus threads with fully formed roots and flat crests) shall not be less than L2 (effective length of external thread) required by American National Standard for Pipe Threads (ANSI/ASME B1.20.1)

Dimensions are for reference only and subject to change without notice.

Warning for Your Safety

The system designer and user have the sole responsibility to select products suitable for their special application requirements to ensure the proper installation. Operation and maintenance of the product. Application details, material compatibility and product ratings should all be considered in the individual selection. Improper selection or use of products can cause property damage or personal injury. METALOK accepts no liability for any improper selection, installation, operation or maintenance.

SQUARE HEAD PLUG

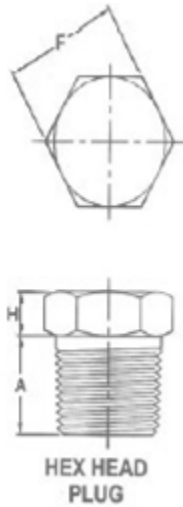

DN	Pipe Size	Length (Min.) A	Square Head Plug	
			Height of Square (Min.) B	Width Flat (Min.) C
6	1/8"	10	6	7
8	1/4"	11	6	10
10	3/8"	13	8	11
15	1/2"	14	10	14
20	3/4"	16	11	16
25	1"	19	13	21
32	1-1/4"	21	14	24
40	1-1/2"	21	16	28
50	2"	22	18	32
65	2-1/2"	27	19	36
80	3"	28	21	41
100	4"	32	25	65

Dimensions are for reference only and subject to change without notice.

Warning for Your Safety

The system designer and user have the sole responsibility to select products suitable for their special application requirements to ensure the proper installation. Operation and maintenance of the product. Application details, material compatibility and product ratings should all be considered in the individual selection. Improper selection or use of products can cause property damage or personal injury. METALOK accepts no liability for any improper selection, installation, operation or maintenance.

HEX HEAD PLUG

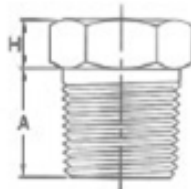
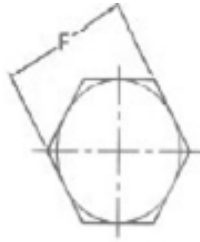

HEX HEAD
PLUG

DN	Pipe Size	Length	Hex. Head Plug & Bushing		
		Min	Width Flat (Nom.) F	Hex. Height (Min.)	
		A		Bushing G	Plug H
6	1/8"	10			6
8	1/4"	11	16	3	6
10	3/8"	13	18	4	8
15	1/2"	14	22	5	8
20	3/4"	16	27	6	10
25	1"	19	36	6	10
32	1-1/4"	21	46	7	14
40	1-1/2"	21	50	8	16
50	2"	22	65	9	18
65	2-1/2"	27	75	10	19
80	3"	28	90	10	21
100	4"	32	115	13	25

Dimensions are for reference only and subject to change without notice.

Warning for Your Safety

The system designer and user have the sole responsibility to select products suitable for their special application requirements to ensure the proper installation. Operation and maintenance of the product. Application details, material compatibility and product ratings should all be considered in the individual selection. Improper selection or use of products can cause property damage or personal injury. METALOK accepts no liability for any improper selection, installation, operation or maintenance.

HEX HEAD BUSHING

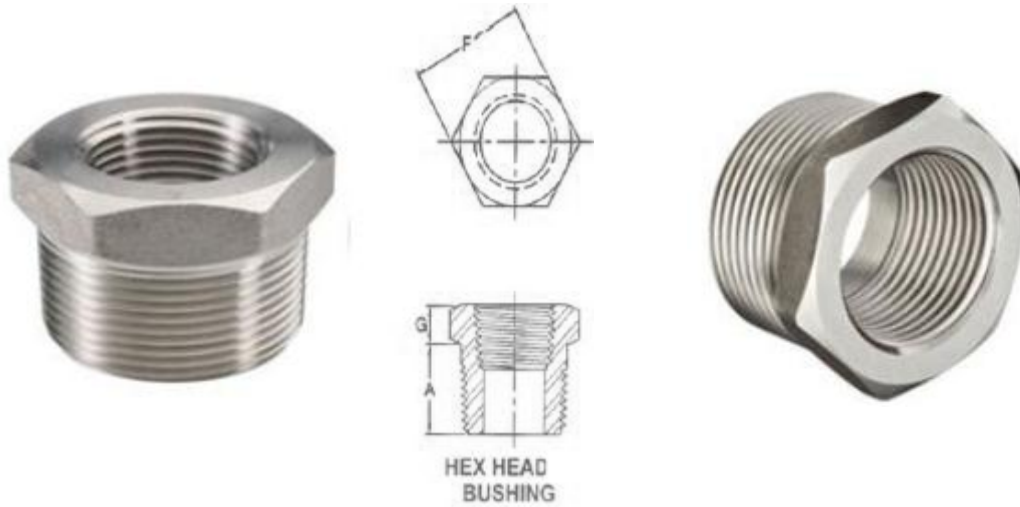

DN	Pipe Size	Length	Hex. Head Plug & Bushing		
		Min	Width Flat (Nom.) F	Hex. Height (Min.)	
		A		Bushing G	Plug H
6	1/8"	10			6
8	1/4"	11	16	3	6
10	3/8"	13	18	4	8
15	1/2"	14	22	5	8
20	3/4"	16	27	6	10
25	1"	19	36	6	10
32	1-1/4"	21	46	7	14
40	1-1/2"	21	5C	8	16
50	2"	22	65	9	18
65	2-1/2"	27	75	10	19
80	3"	28	90	10	21
100	4"	32	115	13	25

Dimensions are for reference only and subject to change without notice.

Warning for Your Safety

The system designer and user have the sole responsibility to select products suitable for their special application requirements to ensure the proper installation. Operation and maintenance of the product. Application details, material compatibility and product ratings should all be considered in the individual selection. Improper selection or use of products can cause property damage or personal injury. METALOK accepts no liability for any improper selection, installation, operation or maintenance.

UNION



H-Thrd's
Minimum 4 Full Thrd's
Engagement Class 2A/2B Fit
ANSI B1.1

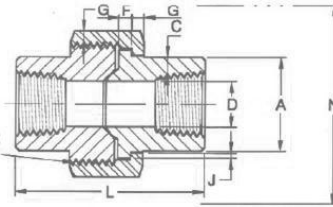

Nom. Pipe Size	Pipe End	Wall	Water Way Bore		Male Flange	Nut	Threads Per 25.4mm	Bearing	Length Assem. Nom.	Clear Assem. Nut
	Min. A	Min. C	D		Min. F	Min. G	Max. H	Min. J	L	N
1/8"	14.7	2.41	8.43	6.43	3.18	3.18	16	1.24	41.4	50.8
1/4"	19.0	3.02	11.13	9.45	3.18	3.18	16	1.24	41.4	50.8
3/8"	22.9	3.20	14.27	13.51	3.43	3.43	14	1.37	46.0	55.9
1/2"	27.1	3.73	17.86	17.07	3.68	3.68	14	1.50	49.0	58.4
3/4"	33.5	3.91	23.01	21.39	4.06	4.06	11	1.68	56.9	66.0
1"	41.4	4.55	28.98	27.74	4.57	4.45	11	1.85	62.0	78.7
1-1/4"	50.5	4.85	37.69	35.36	5.33	5.21	11	2.13	71.1	94.0
1-1/2"	57.2	5.08	43.54	41.20	5.84	5.59	10	2.31	76.5	111.8
T	70.1	5.54	55.58	52.12	6.60	6.35	10	2.69	86.1	132.1
2-1/2"	85.3	7.01	66.27	64.31	7.49	7.11	8	3.07	102.4	149.9
3"	102.4	7.62	88.25	77.27	8.26	8.00	8	3.53	109.0	175.3

Dimensions are for reference only and subject to change without notice.

Warning for Your Safety

The system designer and user have the sole responsibility to select products suitable for their special application requirements to ensure the proper installation. Operation and maintenance of the product. Application details, material compatibility and product ratings should all be considered in the individual selection. Improper selection or use of products can cause property damage or personal injury. METALOK accepts no liability for any improper selection, installation, operation or maintenance.

BULL PLUG

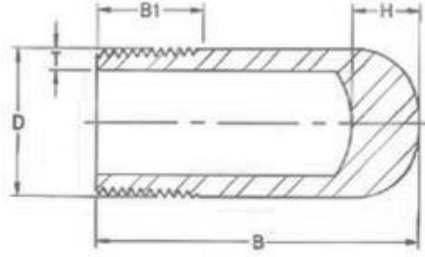

Nom. Pipe Size	D	B	B1	T (Min)				H
				Sch.40 (STD)	Sch.80 (XS)	Sch.160	xxs	
1/8"	10.3	34	9.5	1.73	2.41			14
1/4"	13.7	34	11.0	2.24	3.02			14
3/8"	17.1	57	12.5	2.31	3.20			14
1/2"	21.3	64	14.5	2.77	3.73	4.78	7.47	14
3/4"	26.7	70	16.0	2.87	3.91	5.56	7.82	18
1"	33.4	76	19.0	3.38	4.56	6.35	9.09	18
1-1/4"	42.2	83	23	3.56	4.85	6.35	9.73	18
1-1/2"	48.3	89	20.5	3.68	5.05	7.14	10.15	18
T	60.3	102	22.0	3.91	5.54	8.74	11.07	20
2-1/2"	73.0	127	27.0	5.16	7.01	9.53	14.02	20
3"	88.9	152	28.5	5.49	7.60	11.13	15.24	20
4"	114.3	178	32.0	6.35	8.08	13.49	17.12	20

Dimensions are for reference only and subject to change without notice.

Warning for Your Safety

The system designer and user have the sole responsibility to select products suitable for their special application requirements to ensure the proper installation. Operation and maintenance of the product. Application details, material compatibility and product ratings should all be considered in the individual selection. Improper selection or use of products can cause property damage or personal injury. METALOK accepts no liability for any improper selection, installation, operation or maintenance.



BOSS

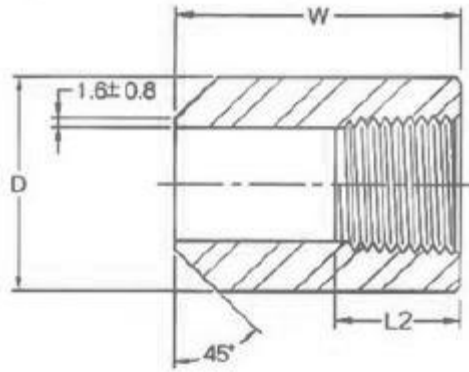

DN	Norn. Pipe Size	D		W		L2 (Min)	
		3000lb	6000lb	3000lb	6000lb	3000lb	6000lb
6	1/8"	16.0	22.0	38.0		6.70	
8	1/4"	19.0	26.0	41.0		10.21	
10	3/8"	22.0	32.0	45.0		10.36	
15	1/2"	29.0	38.0	51.0		13.56	
20	3/4"	35.0	45.0	51.0		13.86	
25	1"	45.0	60.0	51.0		17.34	
40	1-1/2"	64.0	76.0	51.0		18.38	
50	2"	76.0	95.0	51.0		19.22	
65	2-1/2"	95.0		51.0		28.89	
80	3"	110		57.0		30.48	
100	4"	140		64.0		33.02	

Dimensions are for reference only and subject to change without notice.

Warning for Your Safety

The system designer and user have the sole responsibility to select products suitable for their special application requirements to ensure the proper installation. Operation and maintenance of the product. Application details, material compatibility and product ratings should all be considered in the individual selection. Improper selection or use of products can cause property damage or personal injury. METALOK accepts no liability for any improper selection, installation, operation or maintenance.

SWAGE NIPPLES

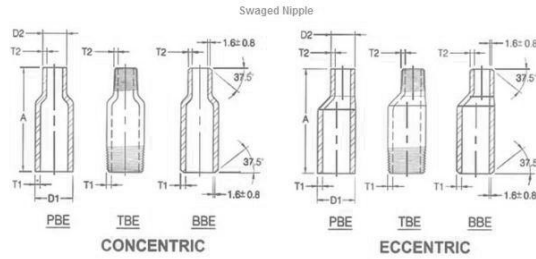

Nominal Pipe Size NPS	Outside Large End D1	Diameter Small End O2	End To End "A"	Wall Thickness							
				T1				T2			
				Sch40 (STD)	Sch80 (XS)	Sdi160	xxs	Sch40 (STD)	Sch80 (XS)	Sch160	XXS
1/4"x1/8"	13.7	10.3	57	2.2	3.0	3.7	6.1	1.7	2.4		
3/8"x1/8"	17.1	10.3	64	2.3	3.2	4.0	6.4	1.7	2.4		
3/8"x1/4"	17.1	13.7	64	2.3	3.2	4.0	6.4	2.2	3.0		
1/2"x1/8"	21.3	10.3	70	2.8	3.7	4.8	7.5	1.7	2.4		
1/2"x1/4"	21.3	13.7	70	2.8	3.7	4.8	7.5	2.2	3.0		
1/2"x3/8"	21.3	17.1	70	2.8	3.7	4.8	7.5	2.3	3.2		
3/4"x1/8"	26.7	10.3	76	2.9	3.9	5.6	7.8	1.7	2.4		
3/4"x1/4"	26.7	13.7	76	2.9	3.9	5.6	7.8	2.2	3.0		
3/4"x3/8"	26.7	17.1	76	2.9	3.9	5.6	7.8	2.3	3.2		
3/4"x1/2"	26.7	21.3	76	2.9	3.9	5.6	7.8	2.8	3.7	4.8	7.5
1" x1/8"	33.4	10.3	89	3.4	4.5	6.4	9.1	1.7	2.4		
1"x1/4"	33.4	13.7	89	3.4	4.5	6.4	9.1	2.2	3.0		
1"x3/8"	33.4	17.1	89	3.4	4.5	6.4	9.1	2.3	3.2		
1"x1/2"	33.4	21.3	89	3.4	4.5	6.4	9.1	2.8	3.7	4.8	7.5
1x3/4"	33.4	26.7	89	3.4	4.5	6.4	9.1	2.9	3.9	5.6	7.8
1-1/4"x1/8"	42.2	10.3	102	3.6	4.9	6.4	9.7	1.7	2.4		
1-1/4"x1/4"	42.2	13.7	102	3.6	4.9	6.4	9.7	2.2	3.0		
1-1/4"x3/8"	42.2	17.1	102	3.6	4.9	6.4	9.7	2.3	3.2		
1-1/4"x1/2"	42.2	21.3	102	3.6	4.9	6.4	9.7	2.8	3.7	4.8	7.5
1-1/4"x3/4"	42.2	26.7	102	3.6	4.9	6.4	9.7	2.9	3.9	5.6	7.8
1-1/4"x1"	42.2	33.4	102	3.6	4.9	6.4	9.7	3.4	4.5	6.4	9.1
1-1/2"x1/8"	48.3	10.3	114	3.7	5.1	7.1	10.2	1.7	2.4		
1-1/2"x1/4"	48.3	13.7	114	3.7	5.1	7.1	10.2	2.2	3.0		
1-1/2"x3/8"	48.3	17.1	114	3.7	5.1	7.1	10.2	2.3	3.2		
1-1/2"x1/2"	48.3	21.3	114	3.7	5.1	7.1	10.2	2.8	3.7	4.8	7.5
1-1/2"x3/4"	48.3	26.7	114	3.7	5.1	7.1	10.2	2.9	3.9	5.6	7.8
1-1/2"x1"	48.3	33.4	114	3.7	5.1	7.1	10.2	3.4	4.5	6.4	9.1
1-1/2"x1-1/4"	48.3	42.2	114	3.7	6.1	7.1	10.2	3.6	4.9	6.4	9.7
2" x1/8"	60.3	10.3	165	3.9	5.5	8.7	11.1	1.7	2.4		
2"x1/4"	60.3	13.7	165	3.9	5.5	8.7	11.1	2.2	3.0		
2"x3/8"	60.3	17.1	165	3.9	5.5	8.7	11.1	2.3	3.2		
2" x1/2"	60.3	21.3	165	3.9	5.5	8.7	11.1	2.8	3.7	4.8	7.5

SWAGE NIPPLES

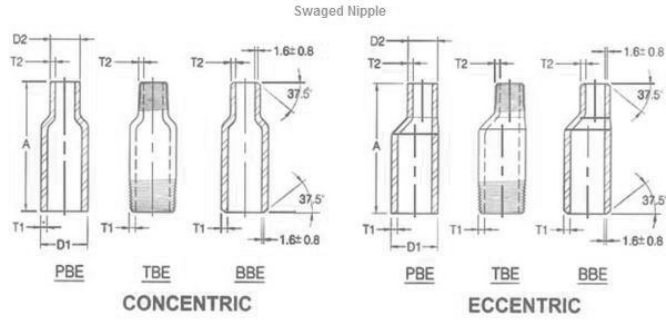

Nominal Pipe ' See (NPS)	Outside Large End D1	Diameter Small End D2	End To End "A"	Wall Thickness							
				T1				T2			
				Sch40 (STD)	Sch80 (XS)	Sch160	xxs	Sch40 (STO)	Sch80 (XS)	Sen 160	XXS
2"X3/4"	60.30	26.7	165	3.9	5.5	8.7	11.1	2.9	39	5.6	7.8
2"x1"	60.30	33.4	165	3.9	5.5	3.7	11.1	3.4	45	6.4	9!
2"x1-1/4"	60.30	42.2	165	3.9	5.5	8.7	11.1	3.6	4.9	6.4	9.7
2"x1-1/2"	60.30	48.3	165	3.9	5.6	8.7	11.1	3.7	5.1	7.1	102
2-1/2"x1/8"	73.0	10.3	178.00	5.2	7.0	9.5	14.0	1.7	2.4		
2-1/2"x1/4"	73.0	13.7	178.00	5.2	7.0	9.5	14.0	2.2	3.0		
2-12"x3/8"	73.0	17.1	178.00	5.2	7.0	9.5	14.0	2.3	3.2		
2-1/2"x1/2"	73.0	21.3	178.00	5.2	7.0	9.5	14.0	2.8	3.7	4.8	7.5
2-1/2"x3/4"	73.0	26.7	178.00	5.2	7.0	9.5	14.0	2.9	39	5.6	7.8
2-1/2"x 1"	73.0	33.4	173	5.2	7.0	9.5	14.0	3.4	45	6.4	9.1
2-1/2"x1-1/4"	73.0	42.2	178	5.2	7.0	9.5	14.0	3.6	4.9	6.4	9.7
2-1/2"x1-1/2'	73.0	48.3	178	5.2	7.0	9.5	14.0	3.7	5.1	7.1	10.2
2-1/2"x 2"	73.0	60.3	178	5.2	7.0	9.5	14.0	3.9	5.6	8.7	11.1
3"x1/8"	88.9	10.3	203	5.5	7.6	11.1	15.2	1.7	2.4	3.2	4.8
3"x1/4"	88.9	13.7	203	5.5	7.6	11.1	15.2	2.2	3.0	3.7	6.1
3"x3/8"	88.9	17.1	203	5.5	7.6	11.1	15.2	2.3	3.2	4.0	6.4
3"x4/2"	88.9	21.3	203	5.5	7.0	11.1	15.2	2.8	3.7	4.8	7.5
3"x3/4"	88.9	26.7	203	5.5	7.6	11.1	15.2	2.9	39	5.6	7.8
3"x1"	88.9	33.4	203	5.5	7.6	11.1	15.2	3.4	45	6.4	9.1
3"x1-1/4'	88.9	42.2	203	5.5	7.6	11.1	15.2	3.6	4.9	6.4	9.7
3"x1-1/2"	88.9	48.3	203	5.5	7.6	11.1	15.2	3.7	5.1	7.1	10.2
3"x2"	88.9	60.3	203	5.5	7.6	11.1	15.2	3.9	5.5	8.7	11.1
3"x2-1/2"	88.9	73.0	203	5.5	7.6	11.1	15.2	5.2	7.0	9.5	14.0
3-1/2"x1/8"	101.6	10.3	203	5.7	8.1			1.7	2.4		
3-1/2"x3/8"	101.6	13.7	203	5.7	8.1			2.2	3.0		
3-1/2"x3/8"	101.6	17.1	203	5.7	8.1			2.3	3.2		
3-1/2"x1/2"	101.6	21.3	203	5.7	8.1			2.8	3.7	4.8	7.5
3-1/2"x3/4"	101.6	26.7	203	5.7	8.1			2.9	3.9	5.6	7.8
3-1/2"x1"	101.6	33.4	203	5.7	8.1			3.4	4.5	6.4	9.1
3-1/2"x1-1/4"	101.6	42.2	203	5.7	8.1			3.6	4.9	6.4	9.7

SWAGE NIPPLES

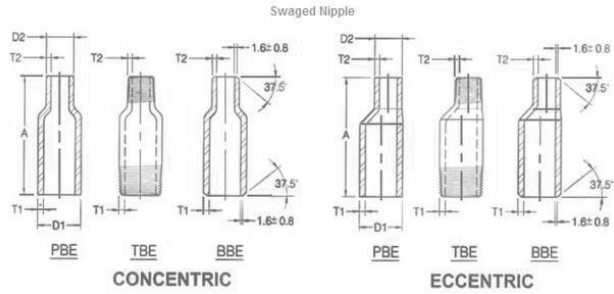

Nominal Pipe Size (NPS)	Outside Large End D1	Diameter Small End D2	End To End "A"	Wall Thickness							
				T1				T2			
				Sch40 (STD)	Sch80 (XS)	Sch160	xxs	Sch40	SchSO (XS)	Sch160	xxs
3-1/2"x1-1/2"	101.6	48.3	203	5.7	8.1			3.7	5.1	7.1	10.2
3-1/2"x2"	101.6	60.3	203	6.7	8.1			3.9	5.5	3.7	11.1
3-1/2"x2-1/2"	101.6	73.0	203	5.7	8.1			5.2	7.0	9.5	14.0
3-1/2"x3"	101.6	88.9	203	5.7	8.1			5.5	7.6	11.1	16.2
4"x1/4"	114.3	13.7	229	6.0	8.6	13.5	17.1	2.2	3.0		
4"x3/8"	114.3	17.1	229	6.0	8.6	13.5	17.1	2.2	3.2		
4"-1/2"	114.3	21.3	229	6.0	8.6	13.5	17.1	2.3	3.7	4.8	7.5
4"x3/4"	114.3	26.7	229	6.0	8.6	13.5	17.1	2.8	3.9	5.6	7.8
4"x1"	114.3	33.4	229	6.0	8.6	13.5	17.1	2.9	4.5	6.4	9.1
4"x1-1/4"	114.3	42.2	229	6.0	8.6	13.5	17.1	3.6	4.9	6.4	9.7
4"x1-1/2"	114.3	48.3	229	6.0	8.6	13.5	17.1	3.7	5.1	7.1	10.2
4"x2"	114.3	60.3	229	6.0	8.6	13.5	17.1	3.9	5.5	8.7	11.1
4"x2-1/2"	114.3	73.0	229	6.0	8.6	13.5	17.1	5.2	7.0	9.5	14.0
4"x3"	114.3	88.9	229	6.0	8.6	13.5	17.1	5.5	7.6	11.1	15.2
4"x3-1/2"	114.3	101.6	229	6.0	8.6	13.5	17.1	5.7	8.1		

Dimensions are for reference only and subject to change without notice.

Warning for Your Safety

The system designer and user have the sole responsibility to select products suitable for their special application requirements to ensure the proper installation. Operation and maintenance of the product. Application details, material compatibility and product ratings should all be considered in the individual selection. Improper selection or use of products can cause property damage or personal injury. METALOK accepts no liability for any improper selection, installation, operation or maintenance.

PIPE NIPPLES

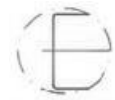

Plain End



Bevel End

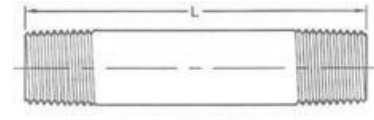

Long Nipple

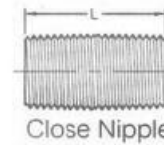

Close Nipple

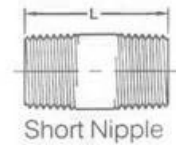

Short Nipple



Nom. Pipe Size	L			Plain End Weight (kg/m)			
	Close Nipple	Short Nipple	Long Nipple	Sch40/STD	Sch80/XS	Sch160	xxs
1/8"	3/4"	1-1/2 "	2-12 "	0.37	0.47		
1/4"	7/8 "	1-1/2 "	2-12 "	0.63	0.80		
3/8"	1	1-1/2 "	2-12 "	0.84	1.10		
1/2"	1-1/8 "	1-1/2 "	2-12 "	1.27	1.62	1.95	2.55
3/4"	1-3/8 "	2	2-12 "	1.69	2.20	2.90	3.64
1"	1-1/2 "	2	2-1/2-12 "	2.50	3.24	4.24	5.45
1-1/4"	1-5/8 "	2-1/2 "	3-12 "	3.39	4.47	5.61	7.77
1-1/2"	1-3/4 "	2-1/2 "	3-12 "	4.05	5.41	7.25	9.55
2"	2	2-1/2 "	3-12 "	5.44	7.48	11.11	13.44
2-1/2"	2-1/2 "	3	3-1/2-12	8.63	11.41	14.92	20.39
3"	2-5/8 "	3	3-1/2-12	11.29	15.27	21.35	27.68
3- 1/2"	2-3/4 "	4	4-1/2-12	13.57	18.64		
4"	2-7/8 "	4	4-1/2-12	16.08	22.32	33.54	41.03
5"	3	4-1/2 "	5-12 "	21.77	30.97	49.12	57.13
6"	3-1/8 "	4-1/2 "	5-12 "	28.26	42.56	67.57	79.22

Dimensions are for reference only and subject to change without notice.

Warning for Your Safety

The system designer and user have the sole responsibility to select products suitable for their special application requirements to ensure the proper installation. Operation and maintenance of the product. Application details, material compatibility and product ratings should all be considered in the individual selection. Improper selection or use of products can cause property damage or personal injury. METALOK accepts no liability for any improper selection, installation, operation or maintenance.

UNION MALE X FEMALE

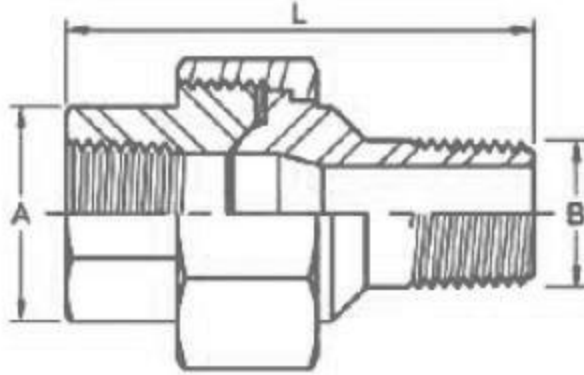

Nom Pipe Size	A2 (Min)	B	L
1/4"	19.0	13.7	55.4
3/8"	22.9	17.1	60.0
1/2"	27.7	21.3	68.0
3/4"	33.5	26.7	75.9
1"	41.4	33.4	86.0
1-1/4"	50.5	42.2	95.1
1-1/2"	57.2	48.3	100.5
2	70.1	60.3	112.1

Dimensions are for reference only and subject to change without notice.

Warning for Your Safety

The system designer and user have the sole responsibility to select products suitable for their special application requirements to ensure the proper installation. Operation and maintenance of the product. Application details, material compatibility and product ratings should all be considered in the individual selection. Improper selection or use of products can cause property damage or personal injury. METALOK accepts no liability for any improper selection, installation, operation or maintenance.



Our Total customer satisfaction results in A True Partnership.



CUSTOMER BASE

More than three decades of experience, expertise and dedication ensures world class quality and excellent performance of METALOK products resulted in establishing worldwide customer base.

GRATITUDE

We at METALOK always appreciated and thankful to all our Valued Customers for undaunted support and faith reposed on us which motivates us to perform better all the time

EDGE

Our in-house Design, manufacturing and Testing facilities only emphasizes that METALOK Fitting and Valves are one of the Best, versatile, safe, compatible, easy for installation and operation in Instrumentation, Hydraulic and Industrial applications.

OUR GOAL

Our company's vision is to understand our customers requirements and meet them fully to their entire satisfaction by way of high quality, timely delivery, competitive price and prompt service.

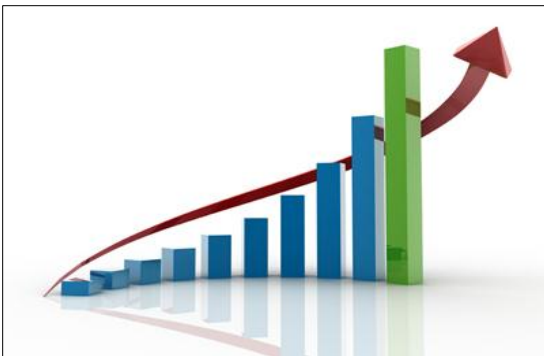



www.metalokindustries.com



METALOK INDUSTRIES

(AN ISO 9001: 2008 Certified Company)

Regd Office & Unit : G-16 & 21, Nikisha Industrial Estate , Near Pandurang wadi, Western Express Highway, Mira Road East, Thane 401 107.

+91 22 28453235

+91 9869552950 (Hassan Shaikh)

+91 9892277161 (Rehan Shaikh)



metalokindustries@gmail.com

sales@metalokindustries.com

metalok@live.com



www.metalokindustries.com



METALOK INDUSTRIES

sales@metalokindustries.com